

Licensing Act 2003

Premises Licence

LEIPRM1396



Leicester
City Council

Local Services & Enforcement
Leicester City Council
York House
91 Granby Street
Leicester
LE1 6FB

(0116) 4543040
licensing@leicester.gov.uk

Part 1 - Premises Details

POSTAL ADDRESS OF PREMISES, OR IF NONE, ORDNANCE SURVEY MAP REFERENCE OR DESCRIPTION

Leicester City Football Club King Power Stadium

Filbert Way, Leicester, LE2 7FL.

WHERE THE LICENCE IS TIME LIMITED THE DATES

Not applicable

Expires **no expiry**

LICENSABLE ACTIVITIES AUTHORISED BY THE LICENCE

- a performance of a play
- an exhibition of a film
- an indoor sporting event
- a boxing or wrestling entertainment
- a performance of live music
- any playing of recorded music
-
- entertainment of a similar description to that falling within entertainment facilities for making music or dancing
- provision of late night refreshment
- the supply of alcohol

THE TIMES THE LICENCE AUTHORISES THE CARRYING OUT OF LICENSABLE ACTIVITIES

Activity (and Area if applicable)	Description	Time From	Time To
A. Performance of a play (Indoors & Outdoors)	Monday to Sunday	Midnight	Midnight
B. Exhibition of films (Indoors & Outdoors)	Monday to Sunday	Midnight	Midnight
C. Indoor sporting event	Monday to Sunday	Midnight	Midnight
D. Boxing or wrestling entertainment (Indoors & Outdoors)	Monday to Sunday	Midnight	Midnight
E. Performance of live music (Indoors & Outdoors)	Monday to Sunday	Midnight	Midnight
F. Playing of recorded music (Indoors & Outdoors)	Monday to Sunday	Midnight	Midnight
G. Performance of dance (Indoors & Outdoors)	Monday to Sunday	Midnight	Midnight
K. Provision of facilities for entertainment of a similar description to that falling within I or J (Indoors & Outdoors)	Monday to Sunday	Midnight	Midnight



Licensing Act 2003

Premises Licence

LEIPRM1396



Leicester
City Council

Local Services & Enforcement
Leicester City Council
York House
91 Granby Street
Leicester
LE1 6FB

(0116) 4543040
licensing@leicester.gov.uk

THE TIMES THE LICENCE AUTHORISES THE CARRYING OUT OF LICENSABLE ACTIVITIES continued ...

Activity (and Area if applicable)	Description	Time From	Time To
I. Late night refreshment (Indoors & Outdoors)	Monday to Sunday	11:00pm	5:00am
J. Supply of alcohol for consumption ON and OFF the premises	Monday to Sunday	Midnight	Midnight

THE OPENING HOURS OF THE PREMISES

Description	Time From	Time To
Monday to Sunday	Midnight	Midnight

WHERE THE LICENCE AUTHORISES SUPPLIES OF ALCOHOL WHETHER THESE ARE ON AND / OR OFF SUPPLIES

- J. Supply of alcohol for consumption ON and OFF the premises

Part 2

NAME, (REGISTERED) ADDRESS, TELEPHONE NUMBER AND EMAIL (WHERE RELEVANT) OF HOLDER OF PREMISES LICENCE

Leicester City Football Club Ltd King Power Stadium, Filbert Way, Leicester, LE2 7FL.

REGISTERED NUMBER OF HOLDER, FOR EXAMPLE COMPANY NUMBER, CHARITY NUMBER (WHERE APPLICABLE)

Leicester City Football Club Ltd 4593477

NAME, ADDRESS AND TELEPHONE NUMBER OF DESIGNATED PREMISES SUPERVISOR WHERE THE PREMISES LICENCE AUTHORISES THE SUPPLY OF ALCOHOL

Richard LYMBERLY

PERSONAL LICENCE NUMBER AND ISSUING AUTHORITY OF PERSONAL LICENCE HELD BY DESIGNATED PREMISES SUPERVISOR WHERE THE PREMISES LICENCE AUTHORISES FOR THE SUPPLY OF ALCOHOL

Licence No. PSL0276 Issued by Erewash



Premises Licence



Leicester
City Council

Local Services & Enforcement
Leicester City Council
York House
91 Granby Street
Leicester
LE1 6FB

(0116) 4543040
licensing@leicester.gov.uk

ANNEXES

Annex 1 - Mandatory conditions

No supply of alcohol may be made under the premises licence -

- a) at a time when there is no designated premises supervisor in respect of the premises licence, or
- b) at a time when the designated premises supervisor does not hold a personal licence or his personal licence is suspended.

Every supply of alcohol under the premises licence must be made or authorised by a person who holds a personal licence.

The responsible person must ensure that staff on relevant premises do not carry out, arrange or participate in any irresponsible promotions in relation to the premises. In this paragraph, an irresponsible promotion means any one or more of the following activities, or substantially similar activities, carried on for the purpose of encouraging the sale or supply of alcohol for consumption on the premises-

- a) games or other activities which require or encourage, or are designed to require or encourage, individuals to-
 - i) drink a quantity of alcohol within a time limit (other than to drink alcohol sold or supplied on the premises before the cessation of the period in which the responsible person is authorised to sell or supplied alcohol), or
 - ii) drink as much alcohol as possible (whether within a time limit or otherwise);
- b) provision of unlimited or unspecified quantities of alcohol free or for a fixed or discounted fee to the public or to a group defined by a particular characteristic in a manner which carries a significant risk of undermining a licensing objective;
- c) provision of free or discounted alcohol or any other thing as a prize to encourage or reward the purchase and consumption of alcohol over a period of 24 hours or less in a manner which carries a significant risk of undermining a licensing objective;
- d) selling or supplying alcohol in association with promotional posters or flyers on, or in the vicinity of, the premises which can reasonably be considered to condone, encourage or glamorise anti-social behaviour or to refer to the effects of drunkenness in any favourable manner;
- e) dispensing alcohol directly by one person into the mouth of another (other than where that other person is unable to drink without assistance by reason of a disability).

The responsible person must ensure that free potable water is provided on request to customers where it is reasonably available.

The premises licence holder or club premises certificate holder must ensure that an age verification policy is adopted in respect of the premises in relation to the sale or supply of alcohol.

The designated premises supervisor in relation to the premises licence must ensure that the supply of alcohol at the premises is carried on in accordance with the age verification policy.

The policy must require individuals who appear to the responsible person to be under 18 years of age (or such older age as may be specified in the policy) to produce on request, before being served alcohol, identification bearing their photograph, date of birth and either-

- a) a holographic mark, or
- b) an ultraviolet feature.

The responsible person shall ensure that-

- a) where any of the following alcoholic drinks is sold or supplied for consumption on the premises (other than alcoholic drinks sold or supplied having been made up in advance ready for sale or supply in a securely closed container) it is available to customers in the following measures-
 - i) beer or cider: ½ pint;
 - ii) gin, rum, vodka or whisky: 25 ml or 35 ml; and
 - iii) still wine in a glass: 125 ml;
- b) these measures are displayed in a menu, price list or other printed material which is available to customers on the premises; and
- c) where a customer does not in relation to a sale of alcohol specify the quantity of alcohol to be sold, the customer is made aware that these measures are available.

A relevant person shall ensure that no alcohol is sold or supplied for consumption on or off the premises for a price which is less than the permitted price.

Admission of children to the exhibition of any film must be in accordance with the recommendations of the British Board of Film Classification for that film. Where permission has been given by the Licensing Authority to show a film not classified by the British Board of Film Classification, the requirements made by the Licensing Authority for the admission of children to the exhibition of that film must be followed.

Annex 2 - Conditions consistent with the operating schedule

Licensable activities may continue between the end of the hours permitted by the licence on New Years Eve and the start of the hours permitted





Leicester
City Council

Local Services & Enforcement
Leicester City Council
York House
91 Granby Street
Leicester
LE1 6FB

(0116) 4543040
licensing@leicester.gov.uk

ANNEXES continued ...

by the licence on New Years Day.

CCTV to be installed, operated and maintained at all times both internally and externally under the direction of the Crime Prevention Officer.

The Designated Premises Supervisor or a person nominated by him shall be in attendance at Leicester City Football Club throughout the period of the designated sporting event who is responsible for securing compliance with the conditions attached to the premises licence.

For the avoidance of doubt, the consumption of intoxicating liquor shall not at any time be permitted on the occasion of a designated sporting event in the terraced areas.

Note: Designated sporting event has the meaning given in the Sporting Events (Control of Alcohol etc) Act 1985.

Temporary bars on level 1 shall be located in a manner which does not affect access or egress from the Great Hall, Reception Lounge and Club Lounge

In the Licence Refreshment Bars on the ground floor the standard hours for the supply of alcohol will cease 15 minutes after the start of the second half of the designated sporting event and recommence 15 minutes after the end of the event

The maximum occupancy for each of the public areas to be used for regulated entertainments will be in accordance with any risk assessment undertaken under the Regulatory Reform (fire safety) order 2005.

Annex 3 - Conditions attached after a hearing by the Licensing Authority

Outdoor concerts utilising amplified music or voice shall be limited to a maximum of 5 events per year.

A music noise limit of 65db LAeq 5 min at 1m from the facade of the nearest noise sensitive premises (As defined by Leicester City Council's Noise Team) for each event shall be set. The end time for the music shall be 22.30 hours.

There will be a noise management plan (NMP) for the control of music events at the King Power Stadium.

The NMP will detail noise conditions that will be agreed with the Leicester City Council's Noise Team prior to the event taking place and provide a sound protocol for the control of music noise levels during the events. This will establish a noise limit at the mixer location prior to the start of the event, based on simultaneous external noise measurements. The music noise levels will then be controlled at the mixer desk to ensure that the off-site noise limits are achieved.



Annex 4 - Plan (1 of 8)

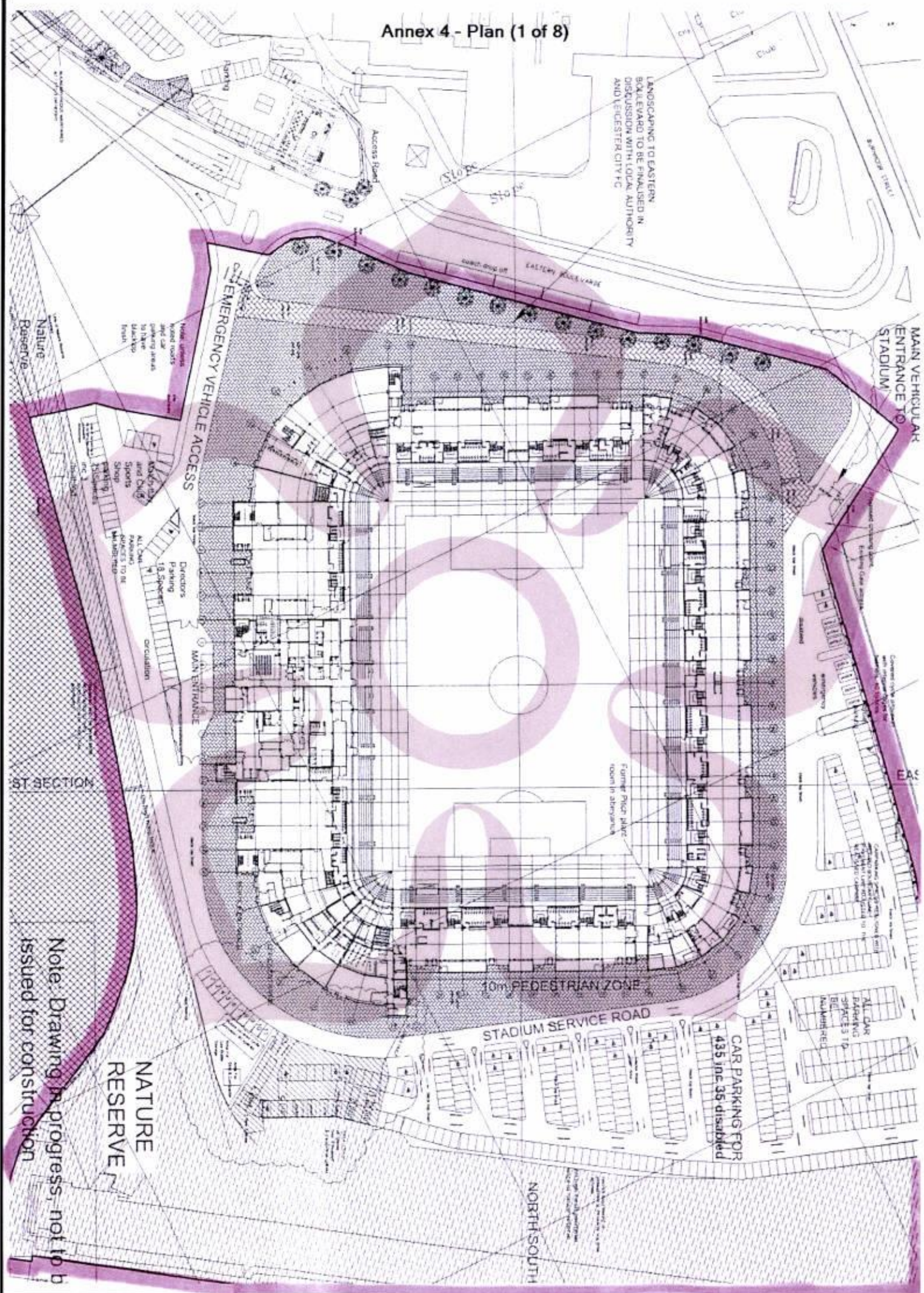

LANDSCAPING TO EASTERN
BOULEVARD TO BE FINALISED IN
DISCUSSION WITH LOCAL AUTHORITY
AND LEICESTER CITY FC

MAIN VEHICULAR
ENTRANCE TO
STADIUM

EMERGENCY VEHICLE ACCESS

Notes: roads
and car
parking areas
to three
levels
North

Directors
Parking
18 Spaces
All Car
Spaces to be
circulation

Former Pitch player
room in alternative

10m PEDESTRIAN ZONE

STADIUM SERVICE ROAD

CAR PARKING FOR
435 inc 35 disabled

ALL CAR
PARKING
SPACES TO
BE
MARKED
WITH RED

NATURE
RESERVE

NORTH SOUTH

Note: Drawing in progress, not to be
issued for construction

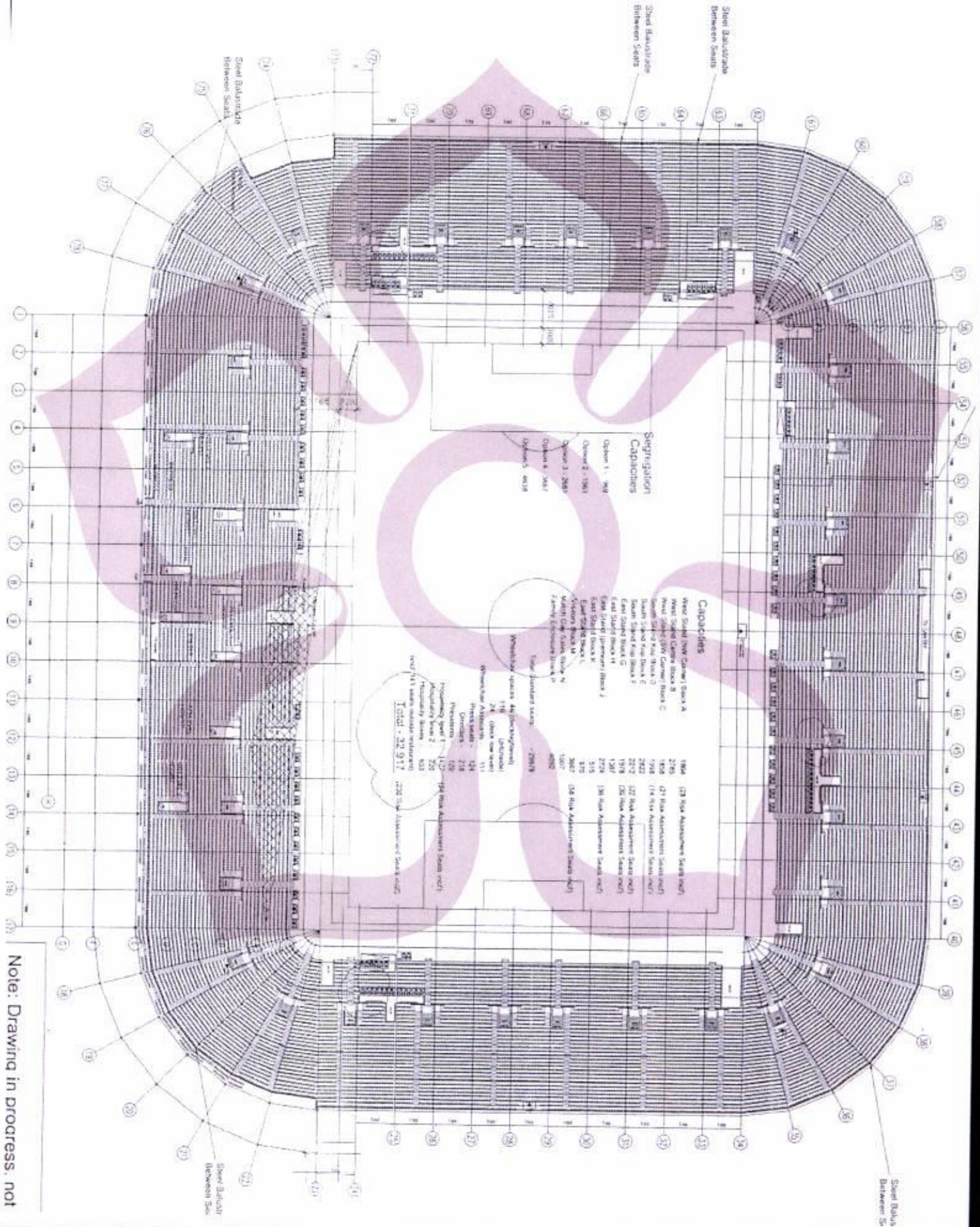

Steel Balustrade
Between Seats

Steel Balustrade
Between Seats

Steel Balustrade
Between Seats

**Segregation
Capacities**

- Open 1 - 948
- Open 2 - 1961
- Open 3 - 2885
- Open 4 - 2867
- Open 5 - 4838

Capacities

- West Stand (NW Corner) Block A - 1864
- West Stand Corner Block B - 2795
- West Stand (SW Corner) Block C - 1826
- South Stand (SW) Block D - 1928
- South Stand (NW) Block E - 2022
- South Stand (SE) Block F - 2012
- East Stand Block G - 1918
- East Stand (inner) Block J - 1287
- East Stand Block H - 2728
- East Stand Block I - 515
- Victoria Block K - 370
- Victoria Block L - 2027
- Victoria Block M - 1587
- Victoria Block N - 4882
- Family Enclosure Block P - 4882

Overall capacity - 28818
(See standard seating)

Men's space (adj. to employment)
178 (calculated)
28 (area not used)

Men's space (adj. to employment)
171
124
111

Directors - 218
Presenters - 128
Frequency zone 1 - 1422 (1st class Admission Seats incl)
Frequency zone 2 - 726
Frequency zone 3 - 523
Total 7143 seats (overall estimated)
TOTAL - 22 917 (22070th Admission Seats incl)

Steel Balustrade
Between Seats

Note: Drawing in progress, not

Annex 4 - Plan (3 of 8)

GROUND FLOOR PLAN

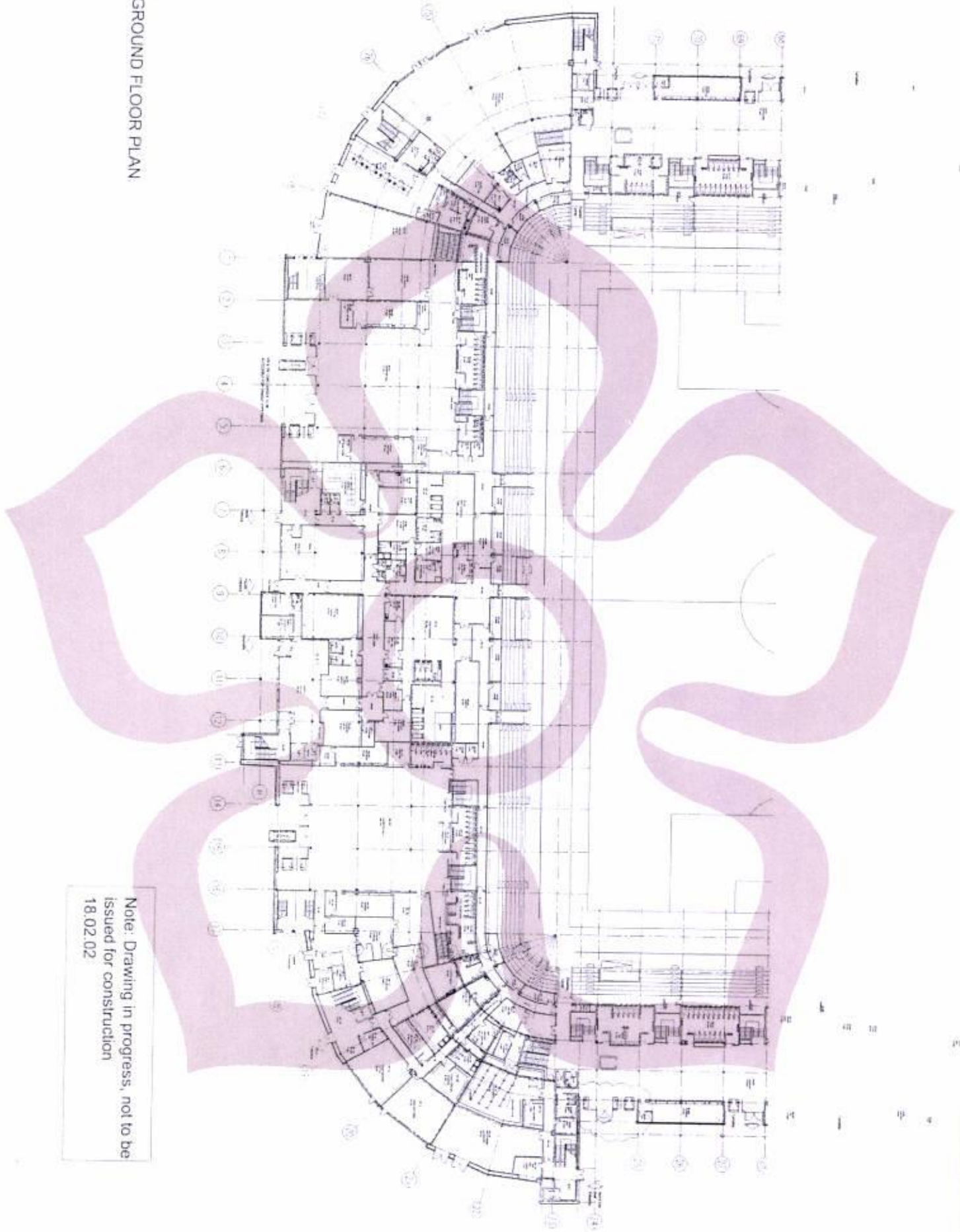

Note: Drawing in progress, not to be issued for construction
18.02.02

MILLER ARCHITECTS 100, 102, 104, 106, 108, 110, 112, 114, 116, 118, 120, 122, 124, 126, 128, 130, 132, 134, 136, 138, 140, 142, 144, 146, 148, 150, 152, 154, 156, 158, 160, 162, 164, 166, 168, 170, 172, 174, 176, 178, 180, 182, 184, 186, 188, 190, 192, 194, 196, 198, 200, 202, 204, 206, 208, 210, 212, 214, 216, 218, 220, 222, 224, 226, 228, 230, 232, 234, 236, 238, 240, 242, 244, 246, 248, 250, 252, 254, 256, 258, 260, 262, 264, 266, 268, 270, 272, 274, 276, 278, 280, 282, 284, 286, 288, 290, 292, 294, 296, 298, 300, 302, 304, 306, 308, 310, 312, 314, 316, 318, 320, 322, 324, 326, 328, 330, 332, 334, 336, 338, 340, 342, 344, 346, 348, 350, 352, 354, 356, 358, 360, 362, 364, 366, 368, 370, 372, 374, 376, 378, 380, 382, 384, 386, 388, 390, 392, 394, 396, 398, 400, 402, 404, 406, 408, 410, 412, 414, 416, 418, 420, 422, 424, 426, 428, 430, 432, 434, 436, 438, 440, 442, 444, 446, 448, 450, 452, 454, 456, 458, 460, 462, 464, 466, 468, 470, 472, 474, 476, 478, 480, 482, 484, 486, 488, 490, 492, 494, 496, 498, 500, 502, 504, 506, 508, 510, 512, 514, 516, 518, 520, 522, 524, 526, 528, 530, 532, 534, 536, 538, 540, 542, 544, 546, 548, 550, 552, 554, 556, 558, 560, 562, 564, 566, 568, 570, 572, 574, 576, 578, 580, 582, 584, 586, 588, 590, 592, 594, 596, 598, 600, 602, 604, 606, 608, 610, 612, 614, 616, 618, 620, 622, 624, 626, 628, 630, 632, 634, 636, 638, 640, 642, 644, 646, 648, 650, 652, 654, 656, 658, 660, 662, 664, 666, 668, 670, 672, 674, 676, 678, 680, 682, 684, 686, 688, 690, 692, 694, 696, 698, 700, 702, 704, 706, 708, 710, 712, 714, 716, 718, 720, 722, 724, 726, 728, 730, 732, 734, 736, 738, 740, 742, 744, 746, 748, 750, 752, 754, 756, 758, 760, 762, 764, 766, 768, 770, 772, 774, 776, 778, 780, 782, 784, 786, 788, 790, 792, 794, 796, 798, 800, 802, 804, 806, 808, 810, 812, 814, 816, 818, 820, 822, 824, 826, 828, 830, 832, 834, 836, 838, 840, 842, 844, 846, 848, 850, 852, 854, 856, 858, 860, 862, 864, 866, 868, 870, 872, 874, 876, 878, 880, 882, 884, 886, 888, 890, 892, 894, 896, 898, 900, 902, 904, 906, 908, 910, 912, 914, 916, 918, 920, 922, 924, 926, 928, 930, 932, 934, 936, 938, 940, 942, 944, 946, 948, 950, 952, 954, 956, 958, 960, 962, 964, 966, 968, 970, 972, 974, 976, 978, 980, 982, 984, 986, 988, 990, 992, 994, 996, 998, 1000		<p>1. GENERAL NOTES</p> <p>2. MATERIALS</p> <p>3. FINISHES</p> <p>4. STRUCTURE</p> <p>5. SERVICES</p> <p>6. LANDSCAPE</p> <p>7. FURNITURE</p> <p>8. EQUIPMENT</p> <p>9. SIGNAGE</p> <p>10. OTHER</p>	
---	--	--	--

FIRST FLOOR PLAN (WEST)



Note: Drawing in progress, not to be issued for construction
18.02.02

	
MILLER ARCHITECTS 201, Market Street, Johannesburg Telephone: 011 462 2000 Fax: 011 462 2001 Email: info@miller.co.za	
PROJECT NO: 1000000000 CLIENT: UNIVERSITY OF THE WITWATERSRAND PROJECT NAME: JUBILEE CAMPUS DRAWING NO: 1000000000-01	DATE: 18.02.02 SCALE: AS SHOWN DRAWN BY: [Name] CHECKED BY: [Name]

NO.	DESCRIPTION	DATE
1	ISSUED FOR CONSTRUCTION	18.02.02
2	ISSUED FOR CONSTRUCTION	18.02.02
3	ISSUED FOR CONSTRUCTION	18.02.02
4	ISSUED FOR CONSTRUCTION	18.02.02
5	ISSUED FOR CONSTRUCTION	18.02.02
6	ISSUED FOR CONSTRUCTION	18.02.02
7	ISSUED FOR CONSTRUCTION	18.02.02
8	ISSUED FOR CONSTRUCTION	18.02.02
9	ISSUED FOR CONSTRUCTION	18.02.02
10	ISSUED FOR CONSTRUCTION	18.02.02
11	ISSUED FOR CONSTRUCTION	18.02.02
12	ISSUED FOR CONSTRUCTION	18.02.02
13	ISSUED FOR CONSTRUCTION	18.02.02
14	ISSUED FOR CONSTRUCTION	18.02.02
15	ISSUED FOR CONSTRUCTION	18.02.02
16	ISSUED FOR CONSTRUCTION	18.02.02
17	ISSUED FOR CONSTRUCTION	18.02.02
18	ISSUED FOR CONSTRUCTION	18.02.02
19	ISSUED FOR CONSTRUCTION	18.02.02
20	ISSUED FOR CONSTRUCTION	18.02.02
21	ISSUED FOR CONSTRUCTION	18.02.02
22	ISSUED FOR CONSTRUCTION	18.02.02
23	ISSUED FOR CONSTRUCTION	18.02.02
24	ISSUED FOR CONSTRUCTION	18.02.02

SECOND FLOOR PLAN (WEST)

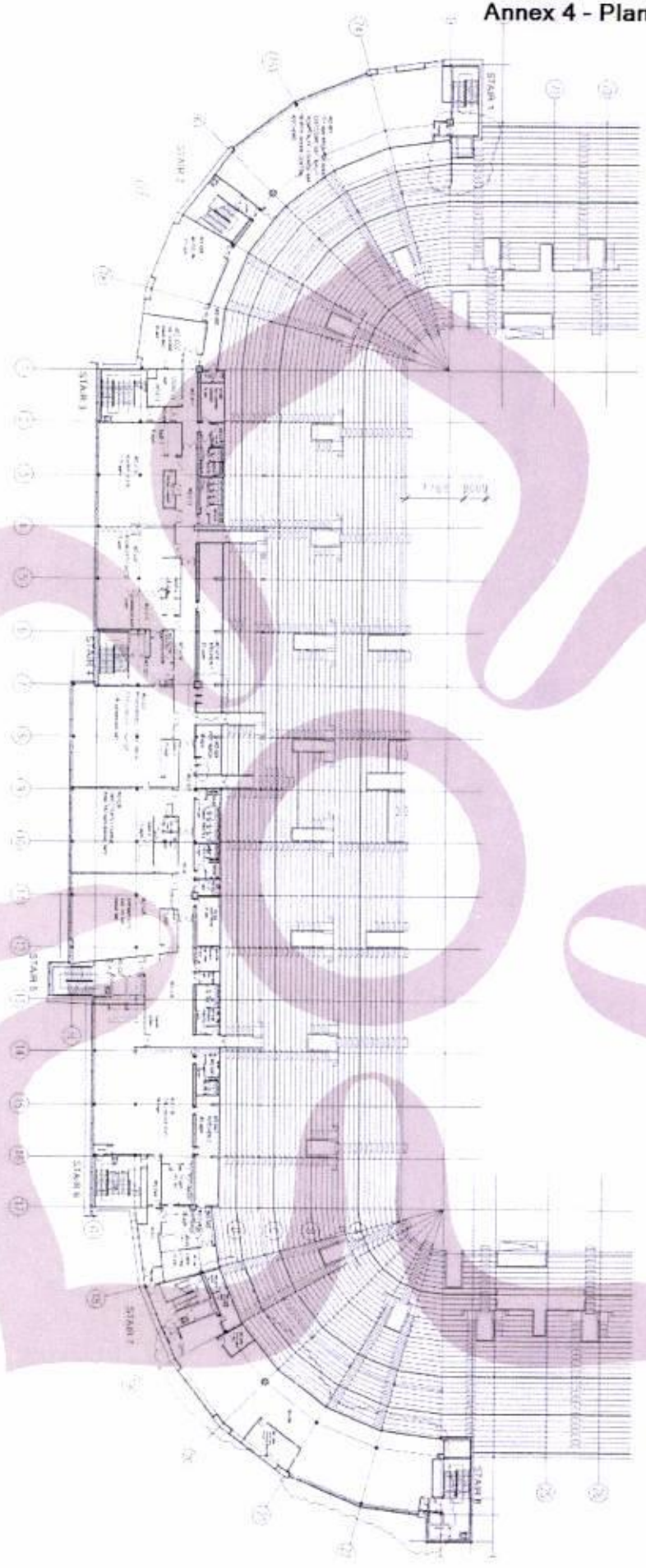

Note: Drawing in progress, not to be issued for construction
18.02.02

		MILLER ARCHITECTS 100, Market Street, Johannesburg	
PROJECT: WITWATERSRAND UNIVERSITY DRAWING: SECOND FLOOR PLAN (WEST) DATE: 18.02.02		SCALE: 1:500 DRAWN BY: [Name] CHECKED BY: [Name]	
PROJECT NO: [Number] DRAWING NO: [Number]		SHEET NO: [Number] TOTAL SHEETS: [Number]	

Annex 4 - Plan (6 of 8)

THIRD FLOOR PLAN

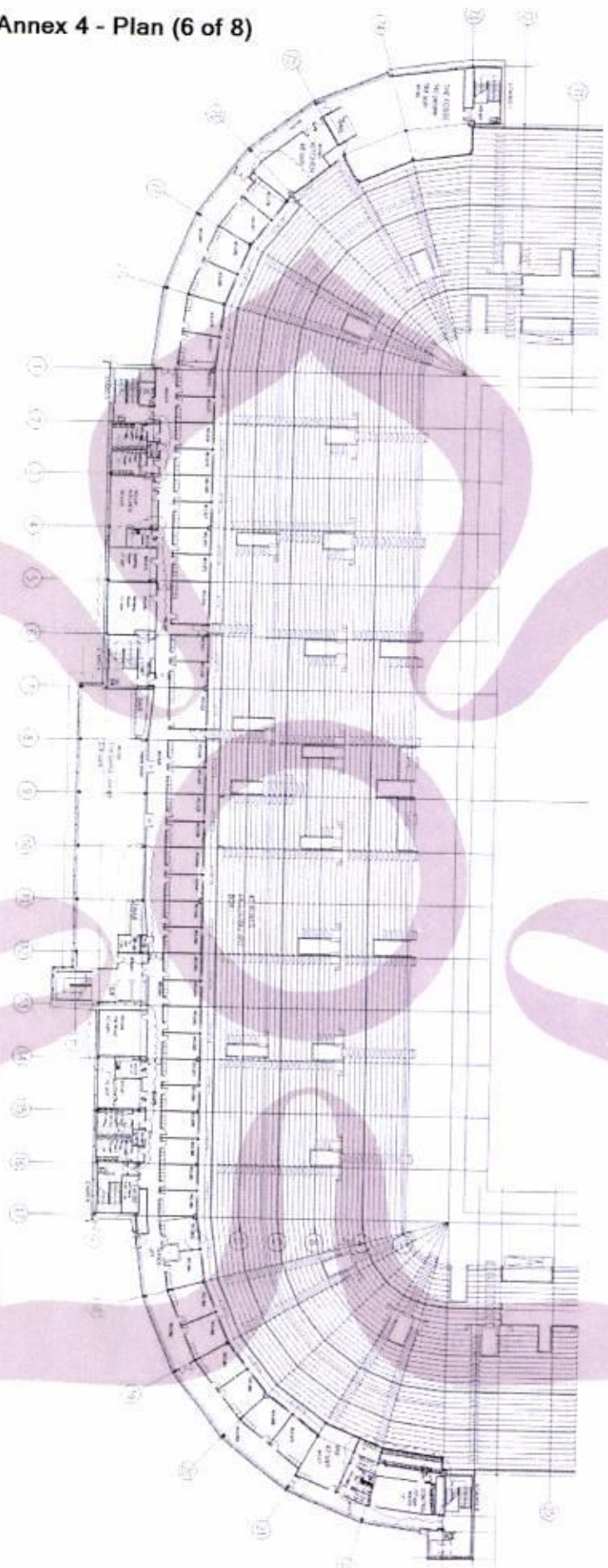

Note: Drawing in progress, not to be issued for construction
18.02.02

NO.	REVISION	DATE
1	ISSUED FOR CONSTRUCTION	18.02.02



MILLER
PARTNERSHIP
ARCHITECTS

REGISTERED ARCHITECTS
101, SANDHURST ROAD
JOHANNESBURG 2008
TEL: 011 551 1111
WWW.MILLERARCHITECTS.CO.ZA

DATE	18.02.02
SCALE	1:100
PROJECT	ANNEX 4
DRAWN BY	...
CHECKED BY	...
DATE	18.02.02

GROUND FLOOR PLAN (EAST)

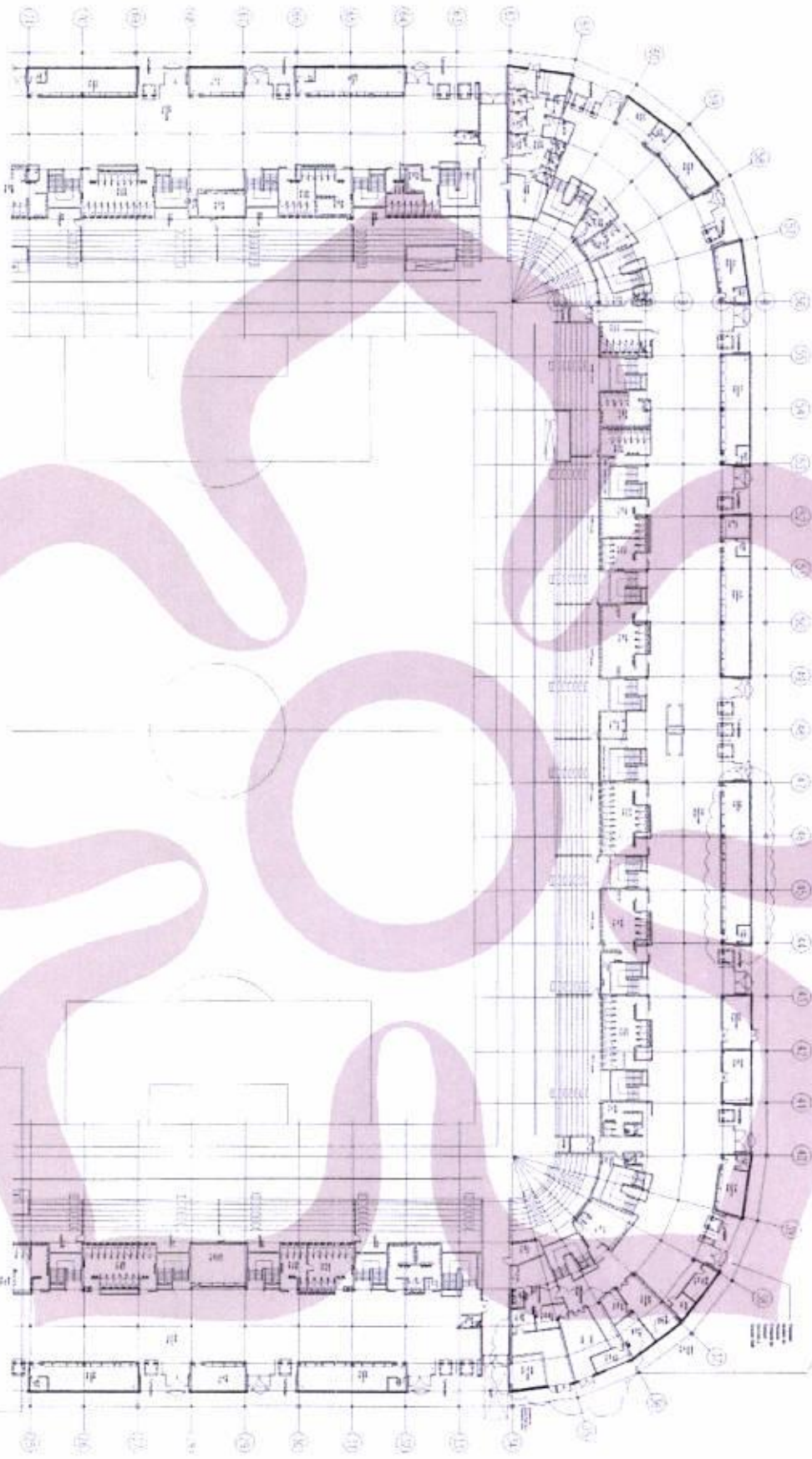

Note
Pitch Room in Advance.

Note: Drawing in progress, not to be issued for construction
18.02.02

NO.	DESCRIPTION	DATE
1	ISSUED FOR CONSTRUCTION	18.02.02
2	REVISED	
3	REVISED	
4	REVISED	
5	REVISED	
6	REVISED	
7	REVISED	
8	REVISED	
9	REVISED	
10	REVISED	
11	REVISED	
12	REVISED	
13	REVISED	
14	REVISED	
15	REVISED	
16	REVISED	
17	REVISED	
18	REVISED	
19	REVISED	
20	REVISED	
21	REVISED	
22	REVISED	
23	REVISED	
24	REVISED	
25	REVISED	
26	REVISED	
27	REVISED	
28	REVISED	
29	REVISED	
30	REVISED	



MILLER
ARCHITECTS
101 BOUTER STREET
Cape Town 7701

NO.	DESCRIPTION	DATE
1	ISSUED FOR CONSTRUCTION	18.02.02
2	REVISED	
3	REVISED	
4	REVISED	
5	REVISED	
6	REVISED	
7	REVISED	
8	REVISED	
9	REVISED	
10	REVISED	
11	REVISED	
12	REVISED	
13	REVISED	
14	REVISED	
15	REVISED	
16	REVISED	
17	REVISED	
18	REVISED	
19	REVISED	
20	REVISED	
21	REVISED	
22	REVISED	
23	REVISED	
24	REVISED	
25	REVISED	
26	REVISED	
27	REVISED	
28	REVISED	
29	REVISED	
30	REVISED	

FIRST FLOOR PLAN (EAST)

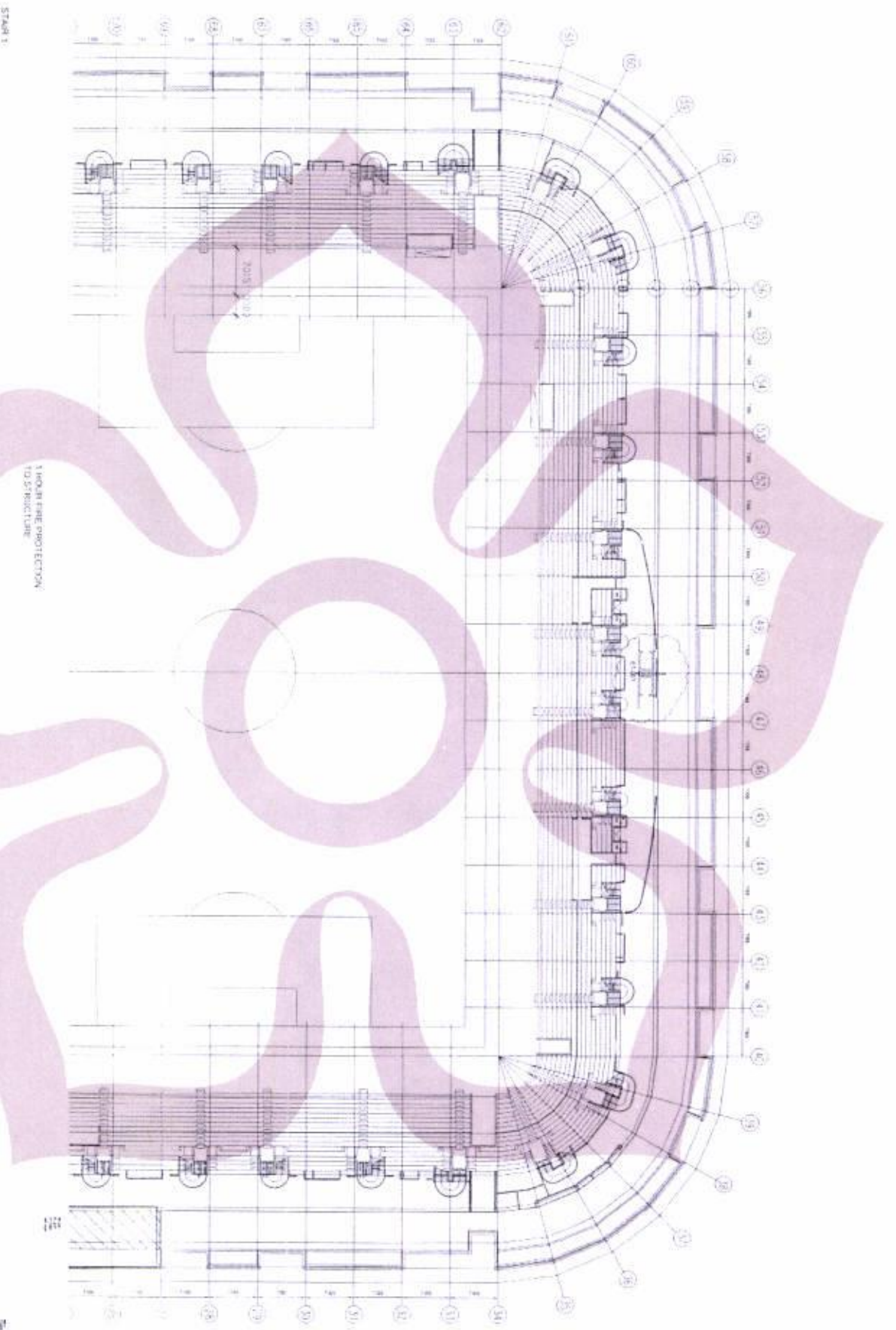

Note: Drawing in progress, not to be issued for construction
18.02.02

MILLER
ARCHITECTS
1000 WEST 10TH AVENUE
DENVER, CO 80202
TEL: 303.733.1111
WWW.MILLERARCHITECTS.COM

PROJECT: [REDACTED]
DATE: 18.02.02
SCALE: 1/8" = 1'-0"

NO.	REV.	DATE	DESCRIPTION
1	1	18.02.02	ISSUED FOR CONSTRUCTION



DATE	18.02.02
SCALE	1/8" = 1'-0"
PROJECT	[REDACTED]
ARCHITECT	MILLER ARCHITECTS
ENGINEER	[REDACTED]
CONTRACTOR	[REDACTED]

Licensing Act 2003

Premises Licence Summary

LEIPRM1396



Leicester
City Council

Local Services & Enforcement
Leicester City Council
York House
91 Granby Street
Leicester
LE1 6FB

(0116) 4543040
licensing@leicester.gov.uk

Premises Details

POSTAL ADDRESS OF PREMISES, OR IF NONE, ORDNANCE SURVEY MAP REFERENCE OR DESCRIPTION

Leicester City Football Club King Power Stadium

Filbert Way, Leicester, LE2 7FL

WHERE THE LICENCE IS TIME LIMITED THE DATES

Not applicable

LICENSABLE ACTIVITIES AUTHORISED BY THE LICENCE

- a performance of a play
- an exhibition of a film
- an indoor sporting event
- a boxing or wrestling entertainment
- a performance of live music
- any playing of recorded music
-
- entertainment of a similar description to that falling within entertainment facilities for making music or dancing
- provision of late night refreshment
- the supply of alcohol

THE TIMES THE LICENCE AUTHORISES THE CARRYING OUT OF LICENSABLE ACTIVITIES

Activity (and Area if applicable)	Description	Time From	Time To
A. Performance of a play (Indoors & Outdoors)	Monday to Sunday	Midnight	Midnight
B. Exhibition of films (Indoors & Outdoors)	Monday to Sunday	Midnight	Midnight
C. Indoor sporting event	Monday to Sunday	Midnight	Midnight
D. Boxing or wrestling entertainment (Indoors & Outdoors)	Monday to Sunday	Midnight	Midnight
E. Performance of live music (Indoors & Outdoors)	Monday to Sunday	Midnight	Midnight
F. Playing of recorded music (Indoors & Outdoors)	Monday to Sunday	Midnight	Midnight
G. Performance of dance (Indoors & Outdoors)	Monday to Sunday	Midnight	Midnight
K. Provision of facilities for entertainment of a similar description to that falling within I or J (Indoors & Outdoors)	Monday to Sunday	Midnight	Midnight



Premises Licence Summary



Leicester
City Council

Local Services & Enforcement
Leicester City Council
York House
91 Granby Street
Leicester
LE1 6FB

(0116) 4543040
licensing@leicester.gov.uk

THE TIMES THE LICENCE AUTHORISES THE CARRYING OUT OF LICENSABLE ACTIVITIES continued ...

Activity (and Area if applicable)	Description	Time From	Time To
I. Late night refreshment (Indoors & Outdoors)	Monday to Sunday	11:00pm	5:00am
J. Supply of alcohol for consumption ON and OFF the premises	Monday to Sunday	Midnight	Midnight

THE OPENING HOURS OF THE PREMISES

Description	Time From	Time To
Monday to Sunday	Midnight	Midnight

WHERE THE LICENCE AUTHORISES SUPPLIES OF ALCOHOL WHETHER THESE ARE ON AND / OR OFF SUPPLIES

- J. Supply of alcohol for consumption ON and OFF the premises

NAME, (REGISTERED) ADDRESS OF HOLDER OF PREMISES LICENCE

Leicester City Football Club Ltd

King Power Stadium, Filbert Way, Leicester, LE2 7FL.

REGISTERED NUMBER OF HOLDER, FOR EXAMPLE COMPANY NUMBER, CHARITY NUMBER (WHERE APPLICABLE)

Leicester City Football Club Ltd

4593477

NAME OF DESIGNATED PREMISES SUPERVISOR WHERE THE PREMISES LICENCE AUTHORISES THE SUPPLY OF ALCOHOL

Richard LYMBERLY

STATE WHETHER ACCESS TO THE PREMISES BY CHILDREN IS RESTRICTED OR PROHIBITED

None

